

Master gauge Model MGS

Nominal size: 150 mm (6") or 250 mm (10")
ASME B40.100 / EN 837-1 / IS-3624
Accuracy: Class 0.25 (0.25%)

Features

- Rugged construction
- Protection IP66/ IP68
- Usable to full scale
- Easy access for calibration
- Ambient temperature compensation
- Optional external Zero Adjustment

Ranges



-30 in. Hg ... 0 psi up to 0 ... 15,000 psi
-1 ... 0 bar up to 0 ... 1000 bar & kg/cm²
-100 ... 0 kPa up to 0 ... 100,000 kPa



Applications

Test benches
Calibration laboratories
Maintenance and repair shop



Technical specification	MGS	
Dial size in mm	150	250
Construction	cylindrical case	
Measuring principle	Bourdon tube	
Range in kg/cm ² (or bar)	0.6 1 1.6 2.5 4 6 10 16 25 40 60 100 160 250 400 600 700 1000 -1/0 -1/0.6 -1/1.5 -1/3 -1/5 -1/9 -1/15 -1/24	
Overpressure limit	130 % F.S., short time.	
Pressure type	Gauge, vacuum and compound	
Process connection	1/4" 3/8" 1/2" BSP / NPT (M) , M20x1.5 (M) Others on request	
Connection location	Lower, back	
Material		
Pressure connection	Stainless steel 316L, optional Monel	
Tube	Beryllium copper, optional Monel, Nickel alloy	
Case/bayonet ring	Stainless steel 304, optional 316L, Aluminum	
Window	Instrument glass, optional laminated safety glass, acrylic glass	
Dial	Aluminum, black markings on white background, with polished mirror band	
Pointer	Aluminum, black knife edge micrometer adjustment others on request	
Movement	High precision jewel bearing with temperature compensation	
Accuracy	Class 0.25 (0.25% F.S.)	
Permissible		
Ambient temperature	-40 ... 60 °C (-40 ... 140 °F)	
Medium temperature	Max. 100 °C (212 °F)	
Storage temperature	-40 ... 60 °C (-40 ... 140 °F)	
Effect	Automatic compensated	
Protection according	IP66 / IP68	
Optional Approval	Conformity according to 2014/34/EU for mechanical equipment in potential hazardous areas  II 2G Ex h IIC T6..T1 Gb X  II 2D Ex h IIIC T85..T450°C Db X	
Mounting	Standard stem, optional panel, bracket, surface or others on request	
Weight SS/AL in kg	0.88	1.99 / 4.4
Accessories, options	Valves	

General dimensions of SS Enclosure in mm

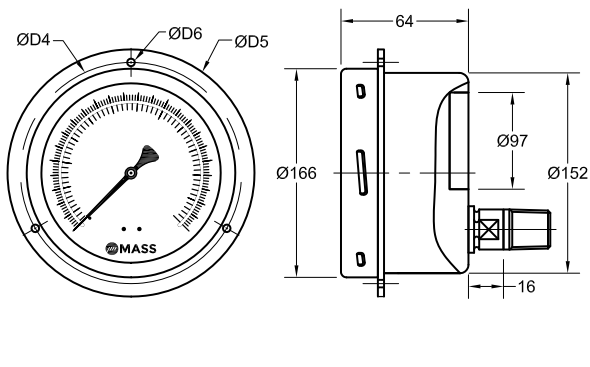
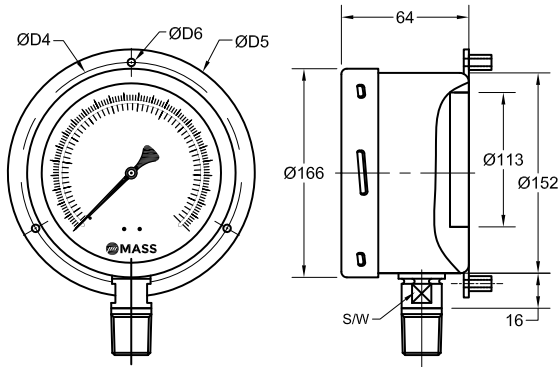

Lower Connection Surface Mounting with Solid Front

Back Connection Front Panel Mounting with Solid Front

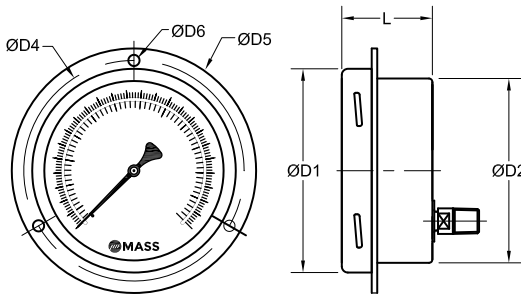
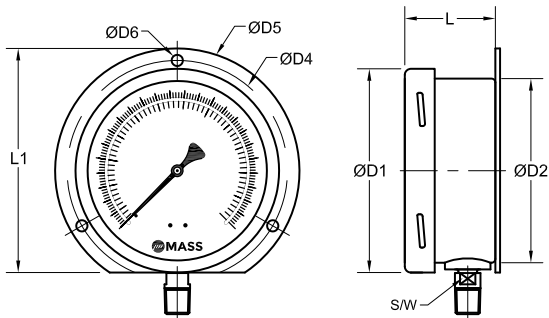

Lower Connection Surface Mounting with Open Front

Back Connection Front Panel Mounting with Open Front

DIAL SIZE	150	250
ØD1	166	265
ØD2	152	252
ØD4	168	276
ØD5	186	290
ØD6	6	7
L	49	53
L1	176	270
SW	17	17

General dimensions of Aluminum Enclosure in mm

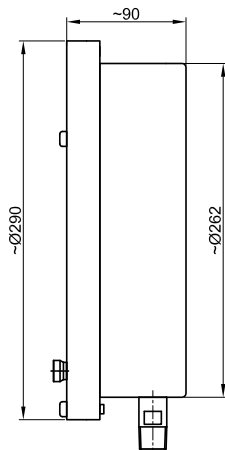
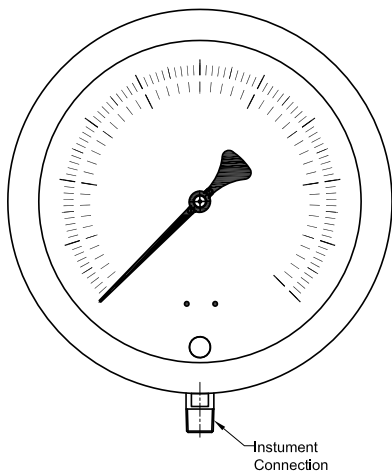

Lower Connection

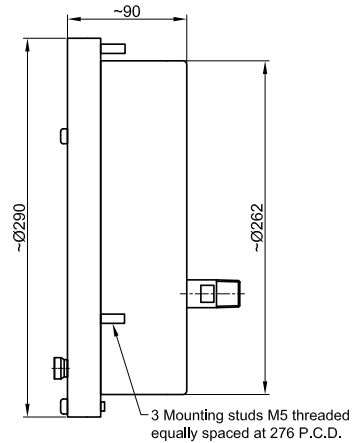

Back Connection

Precision Mass Products Pvt. Ltd.

Plot No.: 2306, G.I.D.C. Chhatral, Ta: Kalol, Dist.: Gandhinagar, Chhatral -382729, Gujarat, India.

Telephone: +91-2764 233681/82/83

Email: sales@precisionmass.com

Fax: +91-2764-233440

www.precisionmass.com

• North Zone : sales.delhi@precisionmass.com

• East zone : sales.kolkata@precisionmass.com

• West zone : sales.mumbai@precisionmass.com

• South zone : sales.chennai@precisionmass.com

Order information

Size	Type	Sensing Tube	Execution	Process connection	Connection orientation	Range	Engineering units	Case material	Options
(150) 150mm	MGS	SS Enclosure	(L) IP66/68	(04)1/2" NPT (M)	(L) Lower	-1/ 0	kg/cm2 (bar)	(=) Standard	(NH) SS wired tag
(250) 250mm		(A) Beryllium copper		(03)3/8" NPT (M)	(B) Back	-1/ 0.6			
		(P) Monel		(02)1/4" NPT (M)		-1/ 1.5		(YW) SS316L Case ¹⁾	(SD) Special Dial
		Aluminum Solid Front Enclosure		(15)1/2" BSP (M)		-1/ 3			(CS) Dual Scale
			(G) Beryllium / Nickle alloy		(14)3/8" BSP(M)		-1/ 5		
				(13)1/4" BSP(M)		-1/ 9			(PD) Acrylic glass
				(16)M20x1.5(M)		-1/ 15			(EZ) External Zero adjustment
						0/ 0.6			(SG) Safety glass
						0/ 1			(FX) Front panel
						0/ 1.6			(FW) Surface plate
						0/ 2.5			(UF) U-clamp ¹⁾
						0/ 4			(SF) Solid front
						0/ 6			(FZ) Front Zero Adjustment
						0/ 10			(AT) ATEX listed
						0/ 16			
						0/ 25			
						0/ 40			
						0/ 60			
						0/ 100			
						0/ 160			
						0/ 250			
						0/ 400			
						0/ 600			
						0/ 700			
						0/ 1000			
								Equivalent ranges in kPa, MPa, psi, bar and others units available	
									Certificate
									(CD3) 3.1 Material Certi.

1) Not for solid front (SF)

How to order

Size	Type	System material	Execution	Process connection	Connection orientation	Range	Engineering unit	Case material	Options	Certificate
150	MGS	A	L	04	L	0/16	BAR	=	NH	CD3

Precision Mass Products Pvt. Ltd.

Plot No.: 2306, G.I.D.C. Chhatral, Ta: Kalol, Dist.: Gandhinagar,
Chhatral -382729, Gujarat, India.
Telephone: +91-2764 233681/82/83
Email: sales@precisionmass.com

Fax: +91-2764-233440
www.precisionmass.com

- North Zone : sales.delhi@precisionmass.com
- East zone : sales.kolkata@precisionmass.com
- West zone : sales.mumbai@precisionmass.com
- South zone : sales.chennai@precisionmass.com