

Flush type flanged diaphragm seal

Model DF50

ASME B40.100

Features

- Welded diaphragm seal
- Variety of wetted parts material
- Filling port in the upper housing
- Suitable for pressure gauges, switches and transmitters

Size

1 ½", 2" & 3" ASME/ANSI
DN40, DN50 & DN80

Pressure Rating

From 150 lbs up to 2500 lbs
From PN10 up to PN160

Applications

Chemical and petrochemical industry
Machine and apparatus construction
Offshore installations
Pulp and paper industry



Technical specification	DF50
Process connection size, flanged ASME B16.5 EN 1092-1	ANSI DIN 1 ½", 2", 3" DN40, DN50, DN80
Rating	ANSI DIN 150 lbs, 300 lbs, 600 lbs, 900 lbs, 1500 lbs, 2500 lbs PN10, PN16, PN25, PN40, PN64, PN100, PN160 others on request
Construction Fill port	Machined flange with welded flush diaphragm In upper housing side with stainless steel ball and set screw
Maximum pressure	According to flange rating
Measuring principle	Diaphragm welded to flange
Instrument connections [female]	3/8" BSP(F), 1/2" NPT(F), Others on request
Sealing surfaces ANSI/ASME EN	B16.5 RF, optional RTJ EN 1092-1 Form B1
Material (wetted parts) Diaphragm & contact surface	Stainless steel 316L, Optional 316L with PFA protection, Hastelloy C276
Material (non wetted parts) Instrument connection Capillary and armor	Stainless steel 304 Stainless steel 316L and stainless steel 304
Filling liquids (temperature range)	Glycerin (0/400 °F, -18/204 °C), Silicone (-50/400 °F, -45/205 °C), Halocarbon (-50/320 °F, -45/160 °C), Syltherm 800 (-40/750 °F, -40/400 °C), Vegetable oil (32/248 °F, 0/120 °C), Food grade silicone (5/570 °F, -15/300 °C), Others on request, also depending on selected material and configuration.
Accuracy	Additional 0.5% to the specified tolerance of the mounted instrument
Mounting	Direct or with capillary
Weight dry in kg	Depending on flange size
Accessories, options	NACE, pressure gauges, pressure switches, transducers, capillaries

General dimensions in mm

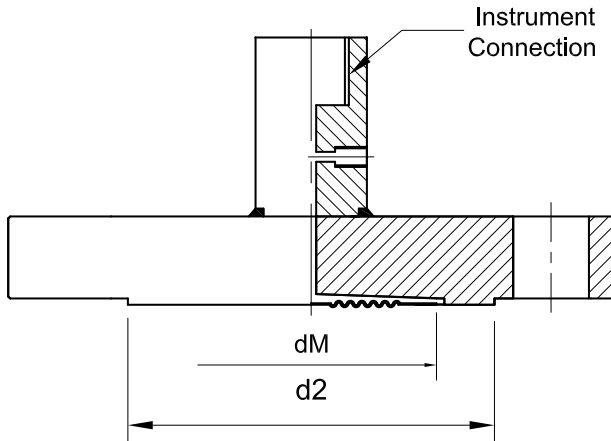

SIZE	RATING	d2	dM	Min.Range Direct mounting (kg/cm ²)	Min.Range with Capillary (kg/cm ²)
1 1/2"	150 ~ 2500#	73	40	4	10
2"	150 ~ 2500#	92	63	1	1
3"	150 ~ 2500#	127	63	1	1
DN 40	PN 10 ~ 160	88	40	4	10
DN 50	PN 10 ~ 160	102	63	1	1
DN 80	PN 10 ~ 160	138	63	1	1

Order information

Process Size	Type	Diaphragm	Flange material	Instrument connection	Flange Rating	Flange Facing	Filling fluid	Length of Capillary
ANSI Flanged (15) 1 1/2" (20) 2" (30) 3"	DF50	(S) SS316L	(S) SS316L	(14T) 3/8 BSP(F)	ANSI	(RF) Raised face ²⁾	(CG) Glycerin (direct mounted, -18/204 °C)	(CA) Stainless steel armored capillary ³⁾
		(SJ) SS316L PFA coated ¹⁾	(SJ) SS316L PFA coated ¹⁾	(04T) 1/2 NPT(F)	(150) 150 lbs (300) 300 lbs (600) 600 lbs (900) 900 lbs (1500) 1500 lbs (2500) 2500 lbs	(RTJ) Ring joint type ²⁾	(CK) Silicone (direct mounted or with capillary, -45/205 °C)	(CP) Stainless steel armored capillary with PVC protection ³⁾
DIN Flanged (DN40) (DN50) (DN80)		(H) Hastelloy C276	(H) Hastelloy C276				(CF) Halocarbon (direct mounted or with capillary, -45/160 °C)	Options
							(HA) Syltherm 800 (direct mounted or with capillary, -40/400 °C)	(NH) SS wired tag (OF) Oil free (only filled with halocarbon)
					DIN (PN10) (PN16) (PN25) (PN40) (PN64) (PN100) (PN160)		(GZ) Vegetable oil (direct mounted or with capillary, 0/120 °C)	Certificate
				others on request			(CZ) Food grade silicone (direct mounted or with capillary, -15/300 °C)	(CD3) 3.1 Material Certi. (CD5) NACE Certificate

1) Restricted to temperature 200 °C 2) The DIN-flange facing depends on nominal size and nominal pressure
3) Max length 30m, specify length in meter EG. CP1.0= CP with 1m

How to order

Process Size	Type	Diaphragm	Flange material	Instrument connection	Flange rating	Flange facing	Filling fluid	Length of Capillary	Options	Certificate
20	DF50	S	S	14T	150	RF	CK	CA1.0	NH	CD3

Precision Mass Products Pvt. Ltd.

Plot No.: 2306, G.I.D.C. Chhatral, Ta: Kalol, Dist.: Gandhinagar, Chhatral -382729, Gujarat, India.

Telephone: +91-2764 233681/82/83

Email: sales@precisionmass.com

Fax: +91-2764-233440

www.precisionmass.com

- North Zone : sales.delhi@precisionmass.com
- East zone : sales.kolkata@precisionmass.com
- West zone : sales.mumbai@precisionmass.com
- South zone : sales.chennai@precisionmass.com